

CONFIDENTIAL NOTICE: This drawing and the design, specifications and engineering information disclosed hereon are the property of Eberhard Manufacturing Company and are not to be disseminated or reproduced without express written consent. The drawing is issued in confidence and is for the consideration of the customer only. In accepting this drawing, the customer agrees to keep it and the matter disclosed hereon in confidence and not to use nor permit their use in any way without the written consent of Eberhard Manufacturing Company, Division of The Eastern Company, 5184 Dublin Road, Cleveland, Ohio 44135-2712, © 2013 EBERHARD MFG. CO.

REV	DESCRIPTION	REVISED BY	DATE	APPROVED BY
1	REVISED, REDRAWN AND CONVERTED TO 3D	889	5-1-13	KAB
1	CHANGED FRONT PLATE, REVISED LEFT VIEW	8841	2/21/2020	MR

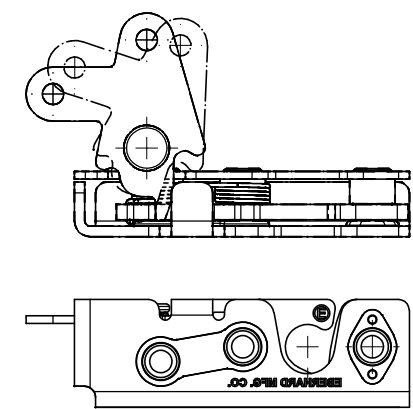

1-475-L
LEFT HAND
LOW PROFILE ROTARY LOCK ASSEMBLY

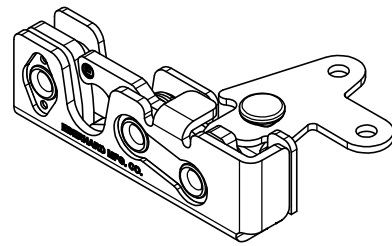
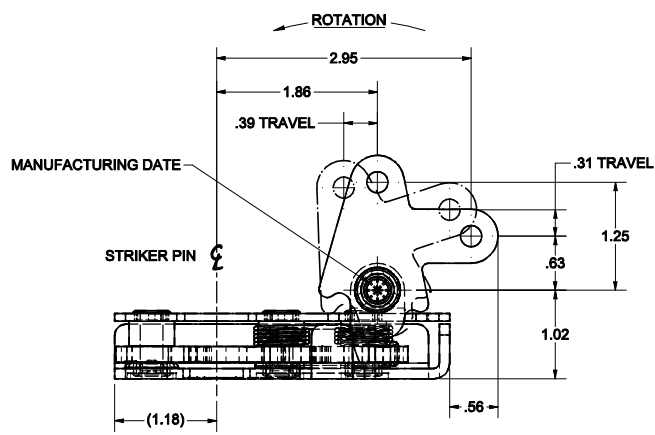
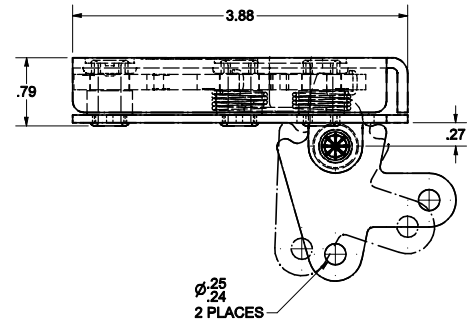
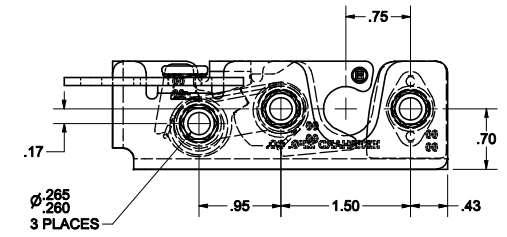
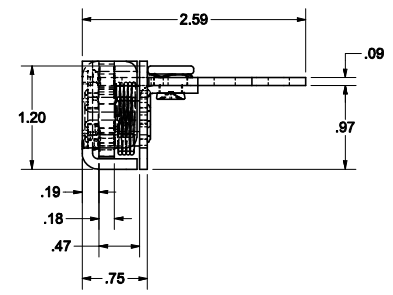
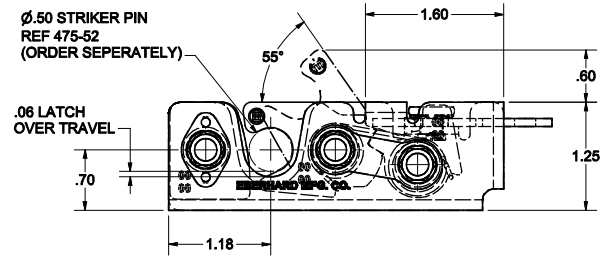

- NOTES:
- THIS ROTARY LOCK ASSEMBLY MEETS ALL REQUIREMENTS FOR FMVSS 206 SAFETY STANDARD WHEN MOUNTED WITH THREE 1/4-20 UNC-2A, GRADE 8 BOLTS.
 - RECOMMENDED TORQUE FOR TIGHTENING: 130 ±10 in./lbs.
 - SPRING RATE:
LATCH: 1.07 lbs.*in. - UNLATCHED POSITION.
PAWL: 1.03 lbs.*in. - ACTUATED POSITION.
 - FINISHES:
A. YELLOW ZINC WITH EVERLUBE INTERNAL COMPONENTS, FC (64)
B. BEARING GREASE WITH EVERLUBE INTERNAL COMPONENTS, FC (BG)

CUSTOMER PRINT
SHEET 1 OF 2
RIGHT HAND SHOWN
LEFT HAND OPPOSITE

EBERHARD MANUFACTURING CO.
DIVISION OF
THE EASTERN COMPANY
CLEVELAND, OHIO 44148-6712

LOW PROFILE ROTARY LOCK ASSEMBLY

THIS DOCUMENT IS IN ACCORDANCE WITH ANSI Y14.5-2009		DATE 8/30/2012	NAME
LINEAR MEASURE: INCH		DATE	NAME
UNLESS OTHERWISE SPECIFIED TOLERANCES ARE AS FOLLOWS:		SCALE	MATERIAL
IN .001		DATE	
MM .01		SCALE	
ANGLES: A2 A2		DATE	
2 PLACE DEC.: A.63 A.76		DATE	PART NUMBER
3 PLACE DEC.: A.015 A.38		DATE	
ALL HOLES: A.005 A.13		DATE	1-475-R



SUPSEDES DRAWING 1-475-R/L SHEET 1 OF 2 DATED 12-23-08.

C:\TEMP\30461\rev4-110-4679-ad65-1d7c3d1e32\F04M751-475-RL_S11.dwg