

CONFIDENTIAL NOTICE: This drawing and the design, specifications and equipment shown hereon are the property of Eberhard Manufacturing Company and are not to be disseminated or otherwise used without express written consent of Eberhard Manufacturing Company. This drawing is intended for the use of the customer and is not to be used for any other purpose without the express written consent of Eberhard Manufacturing Company. All dimensions are in inches unless otherwise noted.

REVISION HISTORY						
REV	DESCRIPTION	EN	DATE	REV. BY	APVD. BY	
1	REDRAWN IN 3D. REFER TO 9911255	5683	12/12/2014	KAB	MR	
1	ADDED NOTE#4, DIMENSION TOLERANCES CHGD	5775	10/21/2016	KAB	MR	

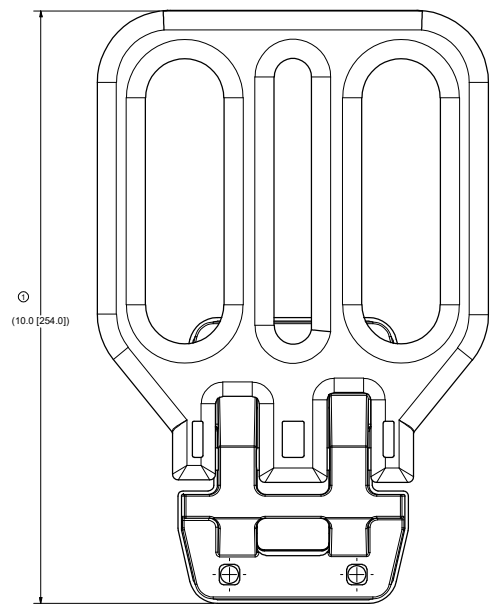
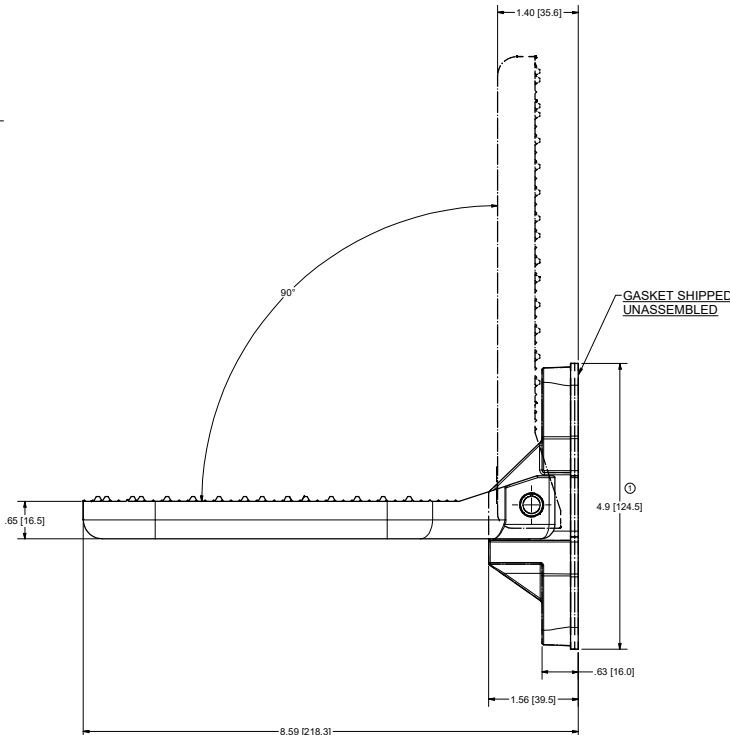
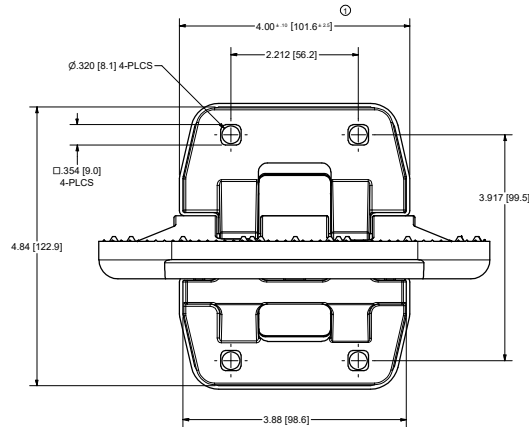
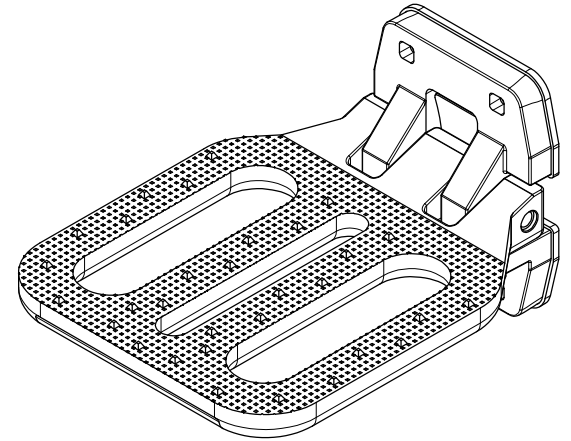
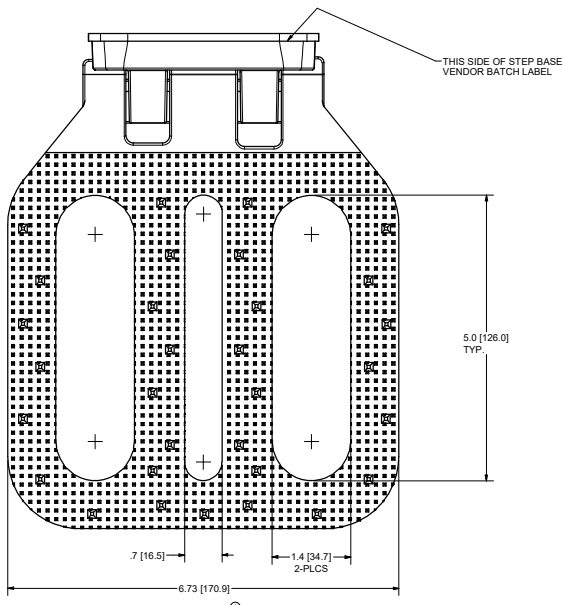

- NOTES:
- 1) EBERHARD FINISH: (05) CHROME FLASH DUPLEX NICKEL.
  - 2) TESTING LOAD CAPACITY: MAX LOAD 1000LBS
  - 3) USE GRADE 8, 5/16 ROUND HEAD OR CARRIAGE HEAD BOLTS FOR INSTALLATION.
  - 4) DIMENSIONS ARE FOR REFERENCE ONLY.

CUSTOMER PRINT  
SHEET 1 OF 2

THIS DOCUMENT IS THE PROPERTY OF EBERHARD MANUFACTURING COMPANY. IT IS TO BE USED ONLY FOR THE PURPOSES SPECIFIED HEREIN. IT IS NOT TO BE REPRODUCED OR TRANSMITTED IN ANY FORM OR BY ANY MEANS, ELECTRONIC OR MECHANICAL, INCLUDING PHOTOCOPYING, RECORDING, OR BY ANY INFORMATION STORAGE AND RETRIEVAL SYSTEM, WITHOUT THE EXPRESS WRITTEN PERMISSION OF EBERHARD MANUFACTURING COMPANY.		EBERHARD MANUFACTURING CO. DIVISION OF THE EASTERN COMPANY CLEVELAND, OHIO 44116-9712
TITLE: FOLDING FOOTSTEP, SQUARE ASSEMBLY DATE: 10/20/14 DRAWN BY: J. J. J.	PART NO.: 16777-PK MATERIAL: DIE CAST ZINC FINISH: 05	QUANTITY: 16777-PK UNIT WEIGHT: 0.8500 UNIT DIMENSIONS: 10.00 X 6.73 X 4.84

SUPERSEDES DRAWING 16777-PK DATED 01-14-06

C:\Working\_Folder\WorkingPrint\1600X16777-PK SH1.dwg