

CONFIDENTIAL NOTICE: This drawing and the designs, specifications and engineering information disclosed hereon are the property of Eberhard Manufacturing Company and are not to be disseminated or reproduced without express written consent. The drawing is loaned in confidence and then only for consideration of the matter disclosed hereon. In accepting loan of this drawing, recipient agrees to keep it and the matter disclosed hereon in confidence and not to use nor permit their use in any way whatsoever by Eberhard Manufacturing Company, Division of the Eastern Company, 21844 Drake Road, Cleveland, Ohio 44148-9712, © 2011 EBERHARD MFG. CO.

REVISION HISTORY			
REV.	DESCRIPTION	EN	DATE
1	REVISED & REDRAWN, CONVERTED TO 3D	EN 8426	10-14-2011
1	MODIFIED SUGGESTED CUTOUT VIEW	8726	10/23/2015

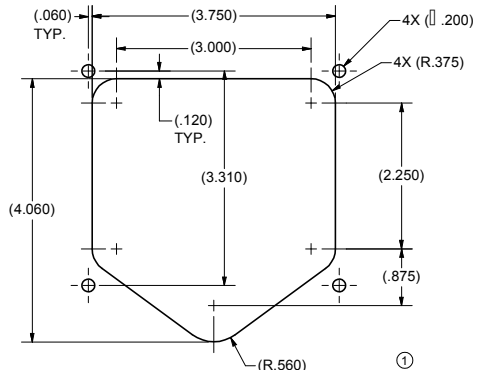

SUGGESTED OUTLINE OF CUTOUT
SCALE .750

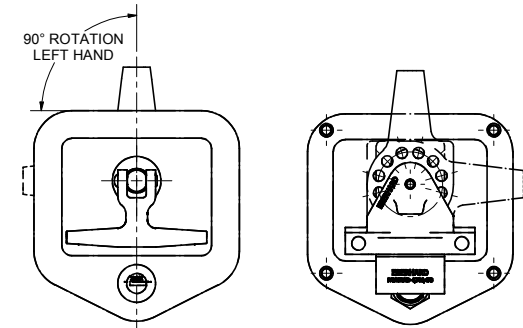
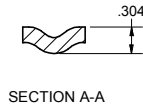

LEFT HAND ASSEMBLY

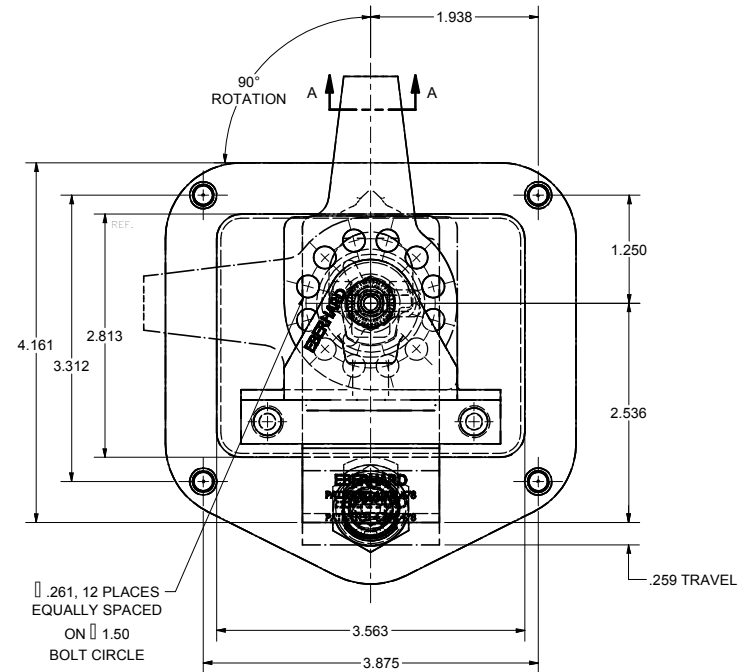
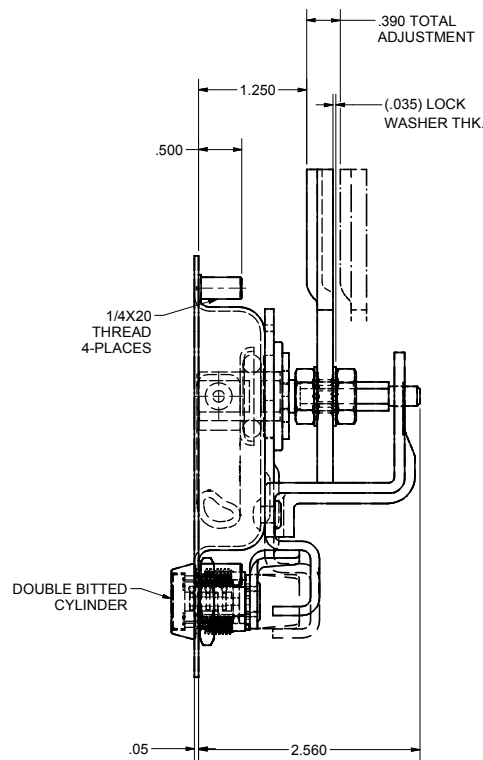
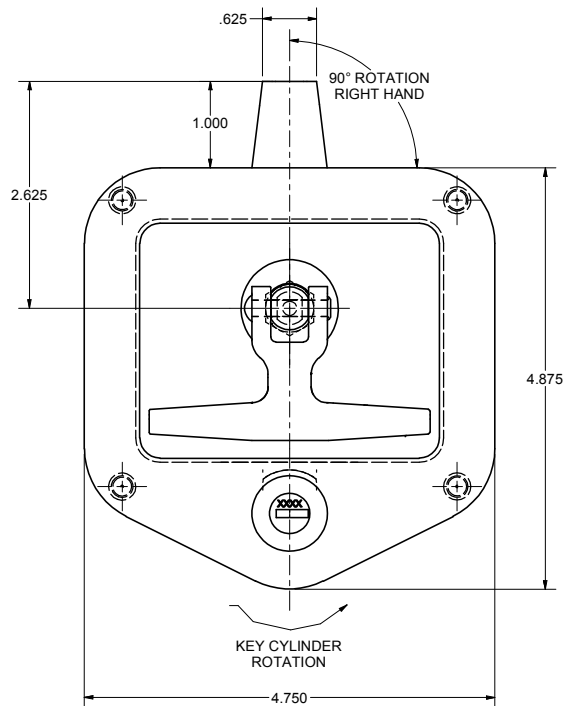

RIGHT HAND SHOWN
LEFT HAND OPPOSITE

CUSTOMER PRINT
SHEET 1 OF 2

- NOTES:
 1. MAX. FASTENER TORQUE ON MTG. STUDS IS 43 IN-LBS.
 2. FINISH - BRIGHT POLISH, FC (10)
 3. KEY NUMBER AVAILABLE: J201-J210 & J236
 4. SUPPLIED WITH 2 KEYS.

EBERHARD MANUFACTURING CO. DIVISION OF THE EASTERN COMPANY CLEVELAND, OHIO 44148-9712	
UNLESS OTHERWISE SPECIFIED TOLERANCES ARE AS FOLLOWS:	10-11-2011
ANGLES: $\pm .01$	MH
2 PLACE DEC.: $\pm .03$	FULL
3 PLACE DEC.: $\pm .015$	
ALL HOLES: $\pm .050$	
DOUBLE BITTED KEY LOCKING FOLDING HANDLE W/ADJUSTABLE LATCH, AND WATER RESISTANT FEATURE	
40-8400DB-SSR/L	