

CONFIDENTIAL NOTICE: This drawing and the designs, specifications and engineering information disclosed hereon are the property of Eberhard Manufacturing Company and are not to be disseminated or reproduced without express written consent. The drawing is loaned in confidence and then only for consideration of the matter disclosed hereon. In accepting loan of this drawing, recipient agrees to keep it and the matter disclosed hereon in confidence and not to use nor permit their use in any way whatsoever by Eberhard Manufacturing Company, Division of the Eastern Company, 2184 Drake Road, Cleveland, Ohio 44143-9712. © 2013 EBBERHARD MFG. CO.

REVISION HISTORY			
REV	DESCRIPTION	EN	DATE
1	CONVERTED TO 3D	5619	8-30-13

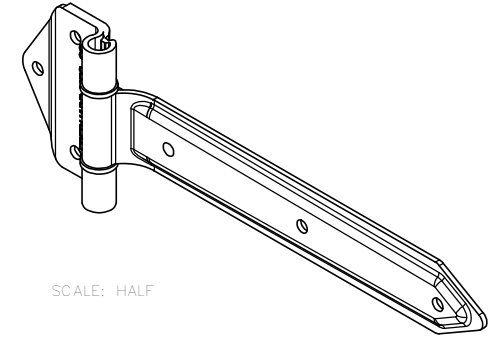

SCALE: HALF

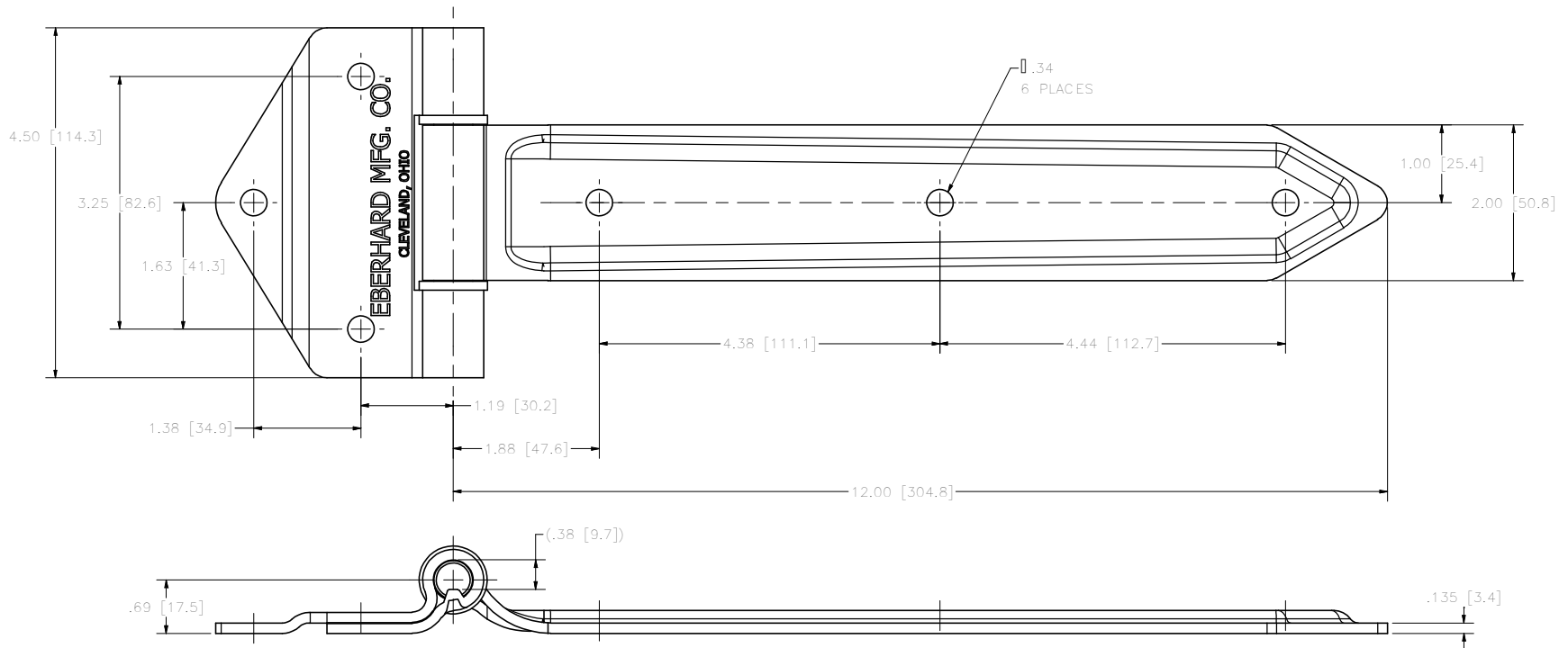

- NOTES:  
 1. FINISHES:  
 A. EBERGUARD II ZINC W/ POLYMER, FC (37)  
 B. HOT DIP GALVANIZED, FC (13)  
 2. METRIC DIMENSION SHOWN AS: [M.M.]

[M.M.]  
 CUSTOMER PRINT  
 SHEET 1 OF 2

**EBBERHARD MANUFACTURING CO.**  
 DIVISION OF  
 THE EASTERN COMPANY  
 CLEVELAND, OHIO 44143-9712

THIS DOCUMENT IS AN ELECTRONIC FILE <small>FORM 114-13-1310</small>	DATE <b>8/30/2013</b>	TIME <small>1:04:58 PM</small>
UNLESS OTHERWISE SPECIFIED <small>TOLERANCES ARE AS FOLLOWS:</small>	FLP	FULL
ANGLES: 0.0 0.0	2 PLACE DEC: 0.03 0.16	3 PLACE DEC: 0.015 0.38
3 PLACE DEC: 0.008 0.13	PART NUMBER: 5870-X	

SUPERSEDES DRAWING 5870-X SHEET 1 OF 2 DATED 6-9-05.